

H650

Nut-style tensioner

Medium temperature

H650 tensioners are used for medium-temperature applications. Preload and torque values are based on a bolt stress of 310 MPa (45,000 psi), the value most commonly used by pressure-vessel designers. Depending on operating temperature, jackbolt torque and preload may be increased.

Components:
1 Nut body
2 Jackbolts
3 Hardened washer

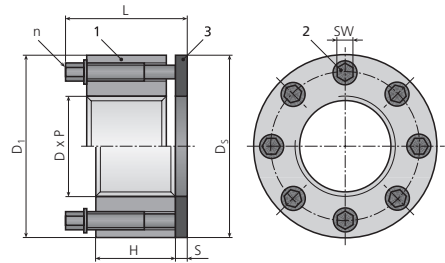

Imperial	Size			Nut body		Jackbolts		Hardened washer		Height	Weight	Preload*	Torque*	
	Thread	Available TPI			1		2		3		tot	est	nom	nom
Part number	D [in]	P ₁	P ₂	P ₃	D ₁ [in]	H [in]	n	SW [in]	D _s [in]	S [in]	L [in]	[Lb]	F [LBf]	M [Lbft]
H650-075-.../W	3/4	10	16	-	1.47	0.70	4	3/16	1.50	0.13	1.38	0.31	13,950	9
H650-087-.../W	7/8	9	14	-	1.60	0.70	6	3/16	1.63	0.13	1.38	0.34	19,790	9
H650-100-.../W	1	8	12	14	1.90	0.93	6	1/4	2.00	0.19	1.71	0.68	27,260	15
H650-112-.../W	1-1/8	7	8	12	2.08	0.93	6	1/4	2.13	0.19	1.71	0.79	35,570	20
H650-125-.../W	1-1/4	7	8	12	2.25	0.94	8	1/4	2.38	0.19	1.71	0.92	44,990	19
H650-137-.../W	1-3/8	6	8	12	2.46	1.20	6	5/16	2.50	0.19	2.12	1.40	55,510	37
H650-150-.../W	1-1/2	6	8	12	2.70	1.20	8	5/16	2.75	0.19	2.12	1.70	67,130	33
H650-162-.../W	1-5/8	6	8	12	2.96	1.20	8	5/16	2.88	0.19	2.12	2.01	79,860	40
H650-175-.../W	1-3/4	5	8	12	3.08	1.42	8	3/8	3.13	0.25	2.49	2.53	93,700	54
H650-187-.../W	1-7/8	6	8	12	3.59	1.60	8	7/16	3.50	0.25	2.85	4.07	108,600	71
H650-200-.../W	2	4.5	8	12	3.59	1.60	8	7/16	3.50	0.25	2.85	3.87	124,700	81
H650-225-.../W	2-1/4	4.5	8	12	3.95	1.60	8	7/16	3.75	0.25	2.85	4.51	160,100	104
H650-250-.../W	2-1/2	4	8	12	4.45	2.10	8	9/16	4.50	0.31	3.61	7.82	199,900	163
H650-275-.../W	2-3/4	4	8	12	4.70	2.10	8	9/16	4.75	0.31	3.61	8.36	244,100	199
H650-300-.../W	3	4	6	8	5.20	2.10	12	9/16	5.00	0.31	3.61	10.30	292,800	159
H650-325-.../W	3-1/4	4	6	8	5.45	2.20	12	9/16	5.00	0.31	3.61	11.04	345,900	188
H650-350-.../W	3-1/2	4	6	8	5.70	2.30	16	9/16	5.50	0.31	3.87	12.62	403,300	164
H650-375-.../W	3-3/4	4	6	8	6.20	2.40	16	9/16	5.50	0.31	3.87	15.08	465,300	189
H650-400-.../W	4	4	6	8	6.45	2.60	18	9/16	6.00	0.31	4.19	17.31	531,600	192
H650-425-.../W	4-1/4	4	6	8	6.95	3.00	16	5/8	6.40	0.38	4.76	23.41	602,300	291
H650-450-.../W	4-1/2	4	6	8	7.20	3.00	16	5/8	6.65	0.38	4.76	24.44	677,500	328
H650-475-.../W	4-3/4	4	6	8	7.45	3.20	18	5/8	6.90	0.38	5.06	27.13	757,100	326
H650-500-.../W	5	4	6	8	7.70	3.30	20	5/8	7.15	0.38	5.06	28.83	841,100	325

* All preload and torque values are provided for general reference. Applied preload plus additional bolt load from service should not exceed the maximum bolt or stud capacity. Contact your local Nord-Lock sales office for assistance in determining proper preload and torque settings for your application.
- Other sizes, thread pitches or thread per inch (TPI) may be available.
- Dimensions listed are representative.

©Copyright 2018 Nord-Lock Group. NORD-LOCK, SUPERBOLT, BOLTIGHT and EXPANDER SYSTEM are trademarks owned by different companies within the Nord-Lock Group. All other logos, trademarks, registered trademarks or service marks used herein are the property of the Nord-Lock Group. All rights reserved.